

# The Reliable Pumps RD 100

## Features

- Inline fluid end design
- Pressure ranges from 8000 PSI to 20000 PSI
- Flow rates from 3.4 GPM up to 18.4 GPM
- High volumetric efficiency for maximum horse-power utilization
- Maximum frame load of 7,000 lbs. / 3178 Kg
- Field proven design
- Extremely reliable — thousands in service
- Easy field maintenance
- Available in all stainless steel fluid end construction
- Manufactured on state-of-the-art machinery
- Rigorously subjected to full load testing

## Applications

- Waterblasting
- Chemical injection
- Boiler feeder
- Process wastewater disposal
- Hydrostatic Testing

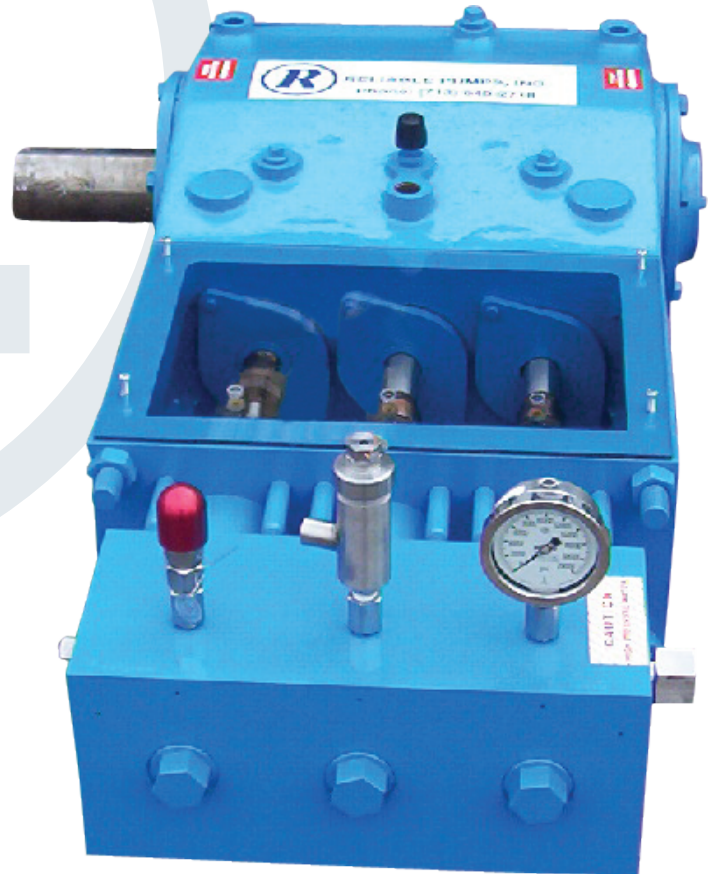

## Performance Specifications

		PSI	BAR	FLOW					
				200 RPM		400 RPM		500 RPM	
RD-100	Plunger Diameter			GPM	LPM	GPM	LPM	GPM	LPM
Note: All flows are based on 100% volumetric efficiency	.625"-15.87mm	20K	1379	2.2	8.3	4.3	16.5	5.4	20.7
	.750"-19mm	15K	1034	3.1	11.9	6.3	23.9	7.9	29.8
	.875"-22.2mm	10K	690	4.3	16.2	8.6	33.4	10.7	40.6
	1"-25.4mm	8K	552	5.6	34.8	11.2	42.4	14	53

Stroke: 2.75"

Max. Speed: 600 RPM

Weight: 760 Lbs.

# The Reliable Pumps RD 100

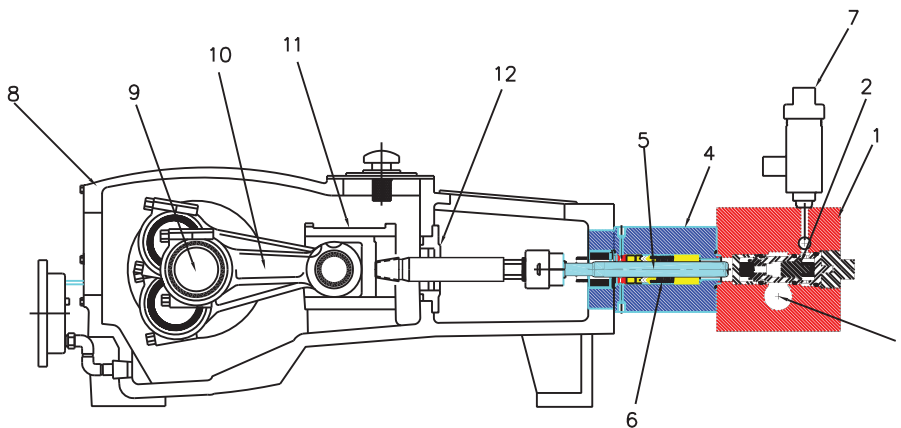

## Fluid End

1. **Fluid Cylinder Body:** Machined from a solid block of stainless steel.
2. **Valves:** Heat-treated stainless steel, spring-loaded for positive closing. Valve seats are straight shoulder with o-ring seals. Both are machined, heat-treated and ground.
3. **Stuffing Boxes:** Machined from heat treated stainless steel.
4. **Plungers:** Carbide coated stainless steel.
5. **Plunger Packing:** Multiple element chevron style, spring-loaded and self-adjusting. Easily replaceable from the rear of the stuffing box. Force-fed water provides lubrication and cooling.
6. **Pressure Relief:** Pressure safety head assembly (rupture disc), integrally mounted in the fluid cylinder. Relief valve is optional.

## Power End

7. **Power Frame:** Manufactured from a single piece casting of high strength gray cast iron.
8. **Crankshaft:** Double extended cast alloy steel with tapered roller bearings to minimize side thrust load. (Optional)
9. **Connecting Rods:** Ductile iron with automotive type split insert bearings.
10. **Crossheads:** Large, piston type constructed of gray iron.
11. **Diaphragm Seals:** Installed with o-rings or gaskets and neoprene oil seals.  
*Bearings and crossheads are oil lubricated with a combined splash gravity system that insures adequate circulation at speeds as low as 200 RPM.*



## Dimensions

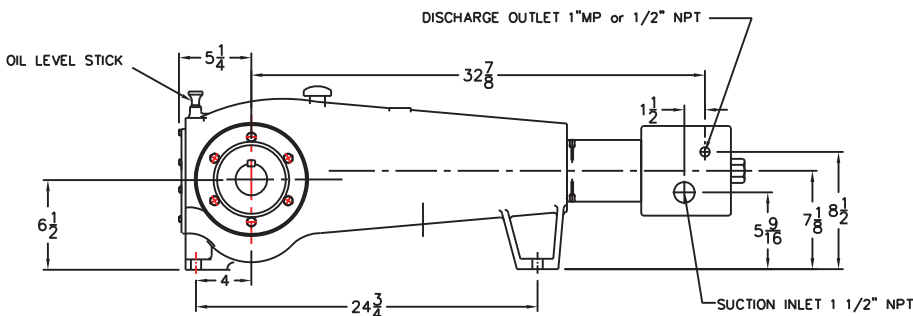

Reliable Pumps Consultants  
5404 Cedar Crest  
Houston, Texas 77033  
Phone: (713) 640-2718  
Fax: (713) 640-1604  
web: [www.reliablepumps.com](http://www.reliablepumps.com)